

- ### THINGS TO SEE
- Old Porky's Tree
 - Hibernaculum
 - Beaver Fast Food
 - Deer Crossing
 - Pileated Woodpecker

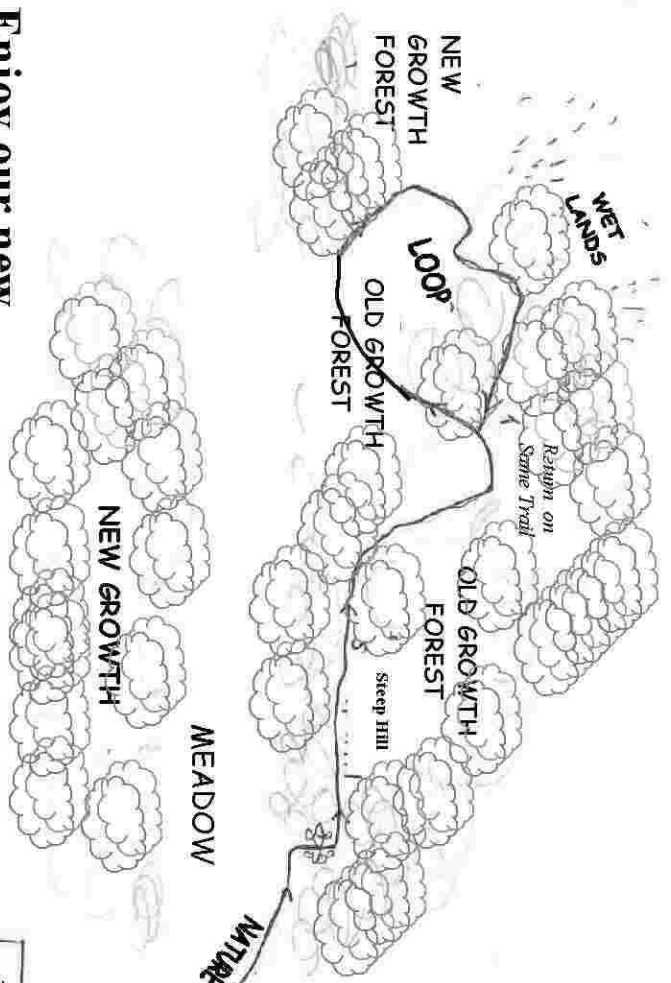

Help support the Trail
And Save the Old
Growth Forest.

Enjoy our new 2km hiking trail (approx.) that takes you over the famous Norwood Esker formed during the last ice age over 12,000 years ago and down through a rare old growth cedar forest. Return for a picnic at the standing stones or the turtle sanctuary. Be careful – slopes and rocks can be slippery. Trek at your own risk.

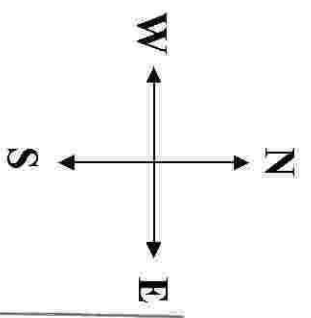
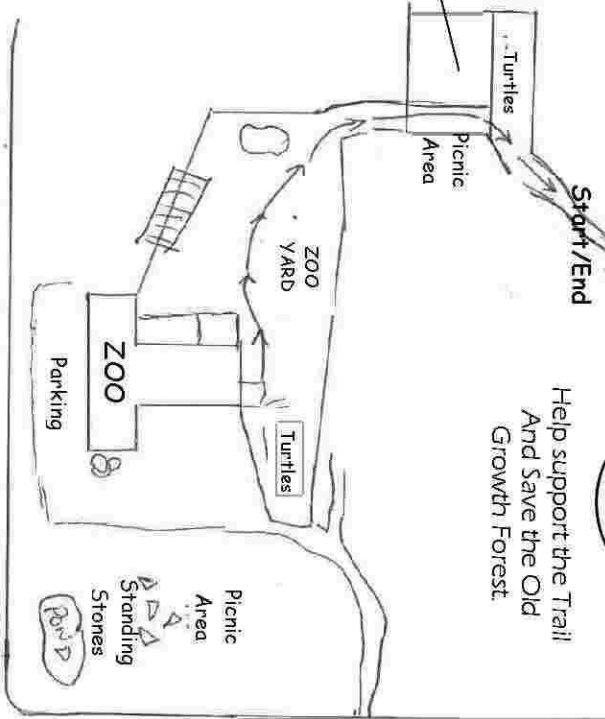

HIGHWAY #7

COUNTY ROAD 38

NATURE



TRAIL MAP